

Data Request Sheet for Doors TT2.1/2.2 - RC3/RC4

Project: _____

Customer: _____ Customer no.: _____

Person in charge: _____ Phone: _____ E-mail: _____

☐ Offer Offer no.: _____ Unit price _____ €,

☐ Order Order no.: _____ Internal base price per unit _____ €, Item: _____, **P** _____

Below you will find our door questionnaire (consisting of four sheets) for the above property. We kindly ask you to fill in the door questionnaire **completely**, confirm the information under point 15 with your signature and return it to us. We would like to point out that the information you provide is a binding part of the contract for the manufacture of the door. The delivery time stated by us begins after the **fully completed** door questionnaire has been returned. **Requested special equipment that is not included in the offer price will only be carried out against payment.**

1. Number of leaves:

☐ Single-leaved door TT2.1 ☐ Double-leaved door TT2.2

2. Resistance class:

☐ RC3 ☐ RC4

Information regarding test certificate for resistance class RC3/RC4 according to DIN EN 1627:

Doors that exceed the maximum dimensions listed below are manufactured in accordance with the test certificate

RC3	Maximum clear wall dimension W x H, single-leaf,	block frame, with test certificate: 1250 x 3000 mm*
	Maximum clear wall dimension W x H, double-leaf,	block frame, with test certificate: 3000 x 3000 mm*
RC4	Maximum clear wall dimension W x H, single-leaf,	block frame, with test certificate: 1250 x 3000 mm*
	Maximum clear wall dimension W x H, double-leaf,	block frame, with test certificate: 2500 x 3000 mm*

*Z-frame: maximum clear wall dimension W x H: 1250 x 2500, or 2500 x 2500 mm

If the door size exceeds customary sheet metal formats, the door leaves are manufactured in several parts.

3. Material:

☐ 1.4307 (AISI 304 L) ☐ 1.4404 (AISI 316 L)

4. Customer provided locking system for euro profile cylinder pc, DIN 18252

Note: As standard, the door is prepared for a Euro profile half cylinder (pc), DIN 18252, with flat key.

Options:

☐ Door prepared for double cylinder (Attention: Door can only be locked from the inside and not locked).
(For locking on the inside, the special equipment "Lockable from inside with second handle" is required).

☐ Digital cylinder for RC4 version. Make: _____ Model: _____

Info: Handle set may have to be checked/adjusted due to core pull protection.

Info: For RC3 version with digital cylinder nothing has to be checked additionally.



5. Shell dimensions:

(Drawing 1)

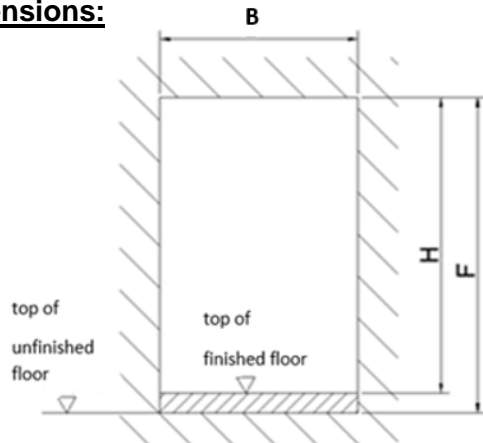

Clear width $B =$ _____ mm

Clear wall opening $F =$ _____ mm

Clear height $H =$ _____ mm

(Please note point 6. sill closure!)

6. Sill closure:

6.1 Standard sill closure:

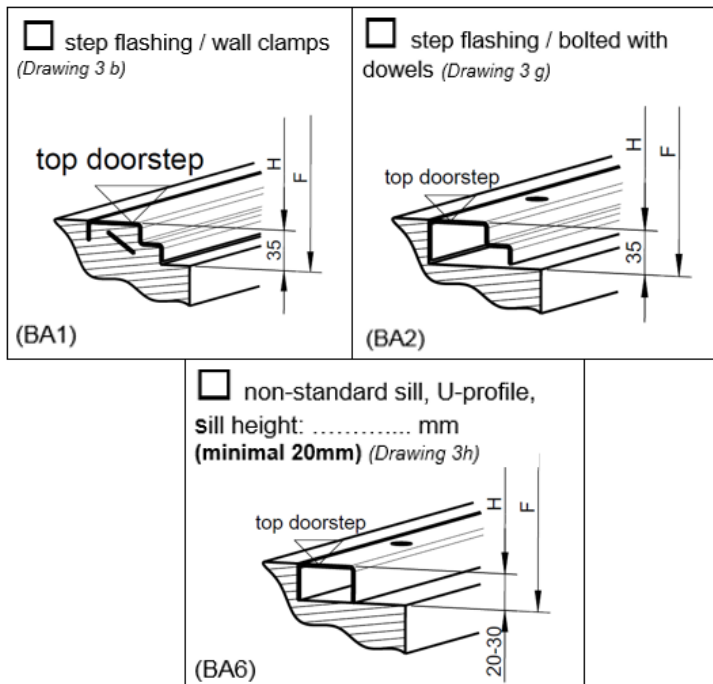

6.2 Special sill closure (surcharge):

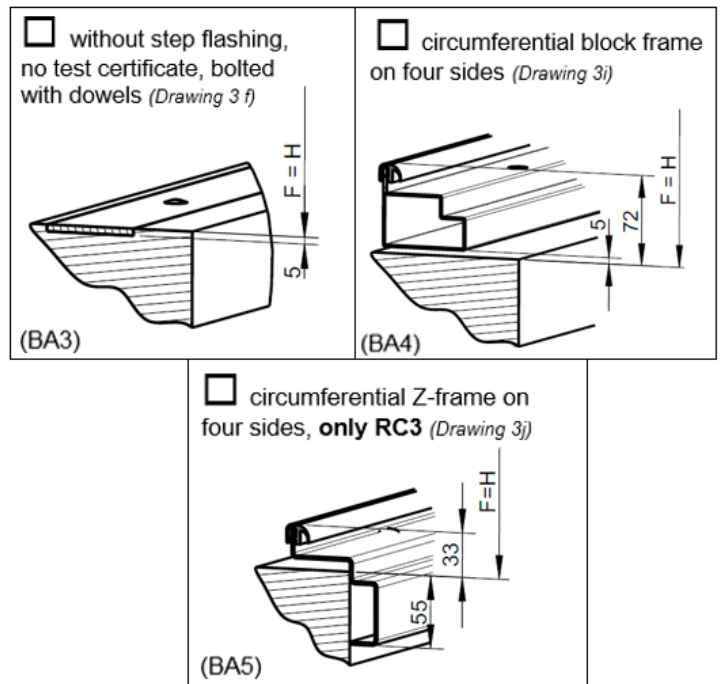

7. Installation situation:

☐ Installation into the lintel
(Z-frame and block frame possible)
(Drawing 2 a)

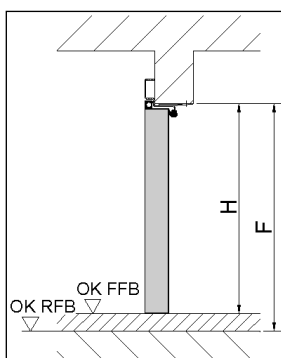

☐ Installation into ceiling-high clearance
(Only block frame possible!)
(Drawing 2 b)

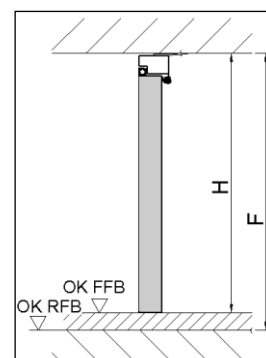

8. Frame and mounting options:

- I.) ☐ Block frame bolted with dowelling clips
(Drawing 4 e)

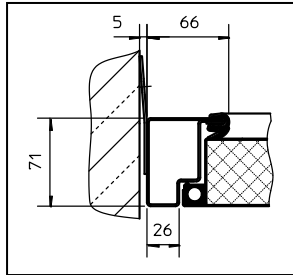

- III.) ☐ Z-frame bolted with dowelling clips
only available for RC3 doors (drawing 4 b)

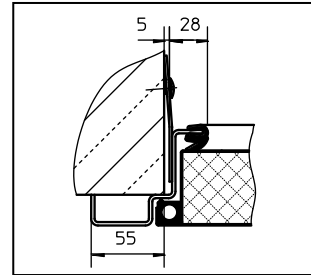

- II.) ☐ Block frame bolted
through the frame, minimum edge distance 80 mm
(Drawing 4 c)

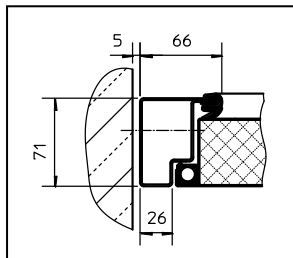

Please note:

For the locking bolts and any special accessories for the frame type "Z-frame", recesses may be required in the on-site door reveal area.

9. Door opening options:

Single-leaved TT2.1

- ☐ hinges on left
(Drawing 5 a)

- ☐ hinges on right
(Drawing 5 b)

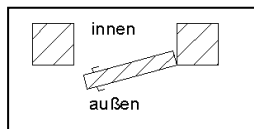
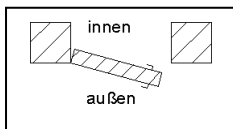

Double-leaved TT2.2 – position of hinges on swing leaf
(as of 1350 mm the door leaf is divided)

- ☐ hinges on left
(Drawing 5 c)

- ☐ hinges on right
(Drawing 5 d)

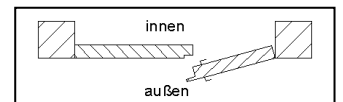
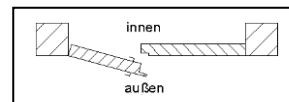

Swing leaf:

Fixable leaf:

_____ mm
(min. 500 mm / max. 1500 mm)

_____ mm
(min 300 mm / max. 1500 mm)

10. Door with rigidly mounted louvre on the outside and fly grid on the inside

- Size: 1 pc. W x H = 400 x 200 mm for **RC4 doors** ☐
1 pc. W x H = 500 x 300 mm for **RC3 doors** ☐
Louvre installation position: in the upper section ☐

- inside fly grid only ☐
inside fly grid + movable louvre ☐
in the lower section ☐

- Double door: in the swing leaf ☐ in the fixable leaf ☐ in both leaves ☐

11. Installation:

☐ by costumer

☐ by HUBER SE

12. Optional equipment:

- | | | |
|--|--|--|
| <input type="checkbox"/> Upper door closer GEZE TS 5000 (door stopper required) | <input type="checkbox"/> swing leaf ≥ 750 mm width | <input type="checkbox"/> fixable leaf ≥ 750 mm width |
| <input type="checkbox"/> Two-piece door arrestor/stop (supplied loose) | <input type="checkbox"/> swing leaf | <input type="checkbox"/> fixable leaf |
| <input type="checkbox"/> One-piece door arrestor (mounted to the door panel), 120 mm lift | <input type="checkbox"/> swing leaf | <input type="checkbox"/> fixable leaf |
| <input type="checkbox"/> Upper door stop manually releasable | <input type="checkbox"/> swing leaf ≥ 750 mm width | <input type="checkbox"/> fixable leaf ≥ 750 mm width |
| <input type="checkbox"/> Lowerable floor seal (for sill closure BA1, BA2, BA6 <u>with</u> test certificate; BA3 <u>without</u> test certificate; BA4 and BA5 <u>not possible</u>) | | |
| <input type="checkbox"/> Lockable from inside with a second handle | | |
| <input type="checkbox"/> Alarm system in door surface | | |
| <input type="checkbox"/> Magnetic contact (door OPEN/SHUT indicator) | <input type="checkbox"/> Swing leaf | <input type="checkbox"/> Fixable leaf |
| <input type="checkbox"/> Lock-bolt contact (door OPEN/SHUT indicator) | | |
| <input type="checkbox"/> Potential equalisation | <input type="checkbox"/> on top of frame | <input type="checkbox"/> on frame bottom |
| <input type="checkbox"/> Heating cable in door frame (without outside temperature sensor, without controls) (HEIZ) | <input type="checkbox"/> in door frame | <input type="checkbox"/> in door panel |
| <input type="checkbox"/> Block frame insulation | | |
| <input type="checkbox"/> Paint RAL colour _____ (RAL...) | <input type="checkbox"/> outside | <input type="checkbox"/> inside |
| <input type="checkbox"/> Additional anti-graffiti lacquer (RAL...) | <input type="checkbox"/> outside | <input type="checkbox"/> inside |
| <input type="checkbox"/> Lock for two side-by-side profile cylinders | | |
| <input type="checkbox"/> Stainless steel rain protection rosette for profile cylinder (only for RC3 doors, cannot be combined with protective fitting) | | |
| <input type="checkbox"/> Rail for rain on top of the frame | | |
| <input type="checkbox"/> Steel sheet finish | | |
| <input type="checkbox"/> Wood panel, wood type: _____ (HOLZ) | | |

Info: In case of sunlight, the operability may be impaired. In these cases, we recommend a steel sheet finish or wood panel. (see special equipment).

13. Other accessories:

14. Delivery address (complete with post code and city)

(If the door is to be supplied directly onto a site, indicate the available unloading times and contact persons on site.)

15. Customer's confirmation:

Customer's representative: _____

Date: _____

Signature: _____

16. Please return this form to:

HUBER contact person: _____

Phone. Nr. +498462/201-

Fax. Nr. +498462/201-399

E-Mail: _____@huber.de

17. Enclosures for the design engineers:

☐ Drawing

☐ Photo

☐