

➤➤ Single security door TT2.1/WK3

Completely made from stainless steel

Security class WK3 is recommended by the criminal investigation department if the building is additionally secured by means of a burglar alarm system.

Certified to security of DIN V ENV 1627, inspection level WK3. Applicable as access to buildings, especially in potable water supply, and for plants with increased security requirements.

Security door, burglar and attack proof, certified to security of DIN V ENV 1627, inspection level WK3, ready for installation, double skinned, completely made from 1.4301/1.4307 stainless steel (AISI 304), with double rubber seal. the door and frame closing flush, the door opening to the outside (in escape direction). Sound insulation: 34/29 dB.

Door, with injected CFCs-free polyurethane hard foam insulation, longitudinally ground surface finish, with rubber seal. Fastened to the frame with stable maintenance-free hinge plates. The door and frame close flush. The closed door engaging flush with the frame by means of solid anchor bolts engaging in the frame for four-point locking. Safety lock with austenitic manganese steel plate provided for profile half cylinder (which is not included in the supply contract; the profile cylinder to be DIN V 18252 – P2 – H – BZ), **with anti-panic lock**, i.e. the door can any time be opened from inside by operating the handle, even when locked. Protective stainless steel fitting, without cylinder cover, with a rigidly mounted handle and a red plastic button inside.

Z-frame, three-sided, fabricated from special section, with inserted rubber seal, with step flashing. Including supply of the associated mounting material.

Frame and door shielded arc-welded and acid bath cleaned before washing, drying and surface passivation.

Ordering options:

Frame / mounting:

- Z-frame
 - Bolted with dowelling clips

Stock frame

- bolted with dowelling clips

- Stock frame – bolted through the frame

Door opening options:

- Hinges on left
- Hinges on right

Special accessories available on request:

- Surface finish (lacquer, copper covering, wooden panelling)
- One/two security ventilation louvre(s) size 500 x 300 mm
- Upper door closer
- One-part or two-part door arrestor
- 1.4571/1.4404 stainless steel
- Anti-graffiti lacquer
- Door heating (heating cable in frame and/or door surface)
- Lock for two side-by-side profile cylinders (that can be opened independently)
- Magnetic contact = door position indicator ('open' – 'closed')
- Lock-bolt contact or bolt position indicator ('open' – 'closed')
- Alarm system in door surface
- Block lock for alarm system
- Lockable from inside with a second handle
- Steel sheet finish for exterior door surface for installations exposed to extreme sunlight
- Stainless steel rain protection rosette
- Stock frame insulation



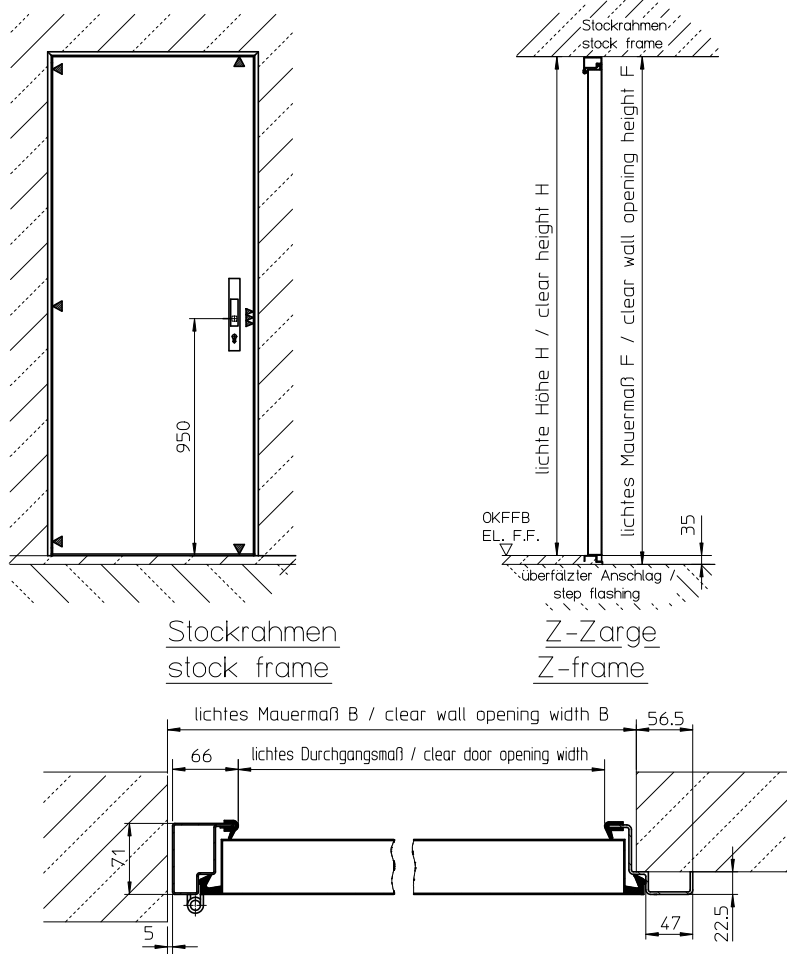

We manufacture to your specifications. Clear wall opening (F) = distance between bottom edge of lintel and top edge of unfinished floor
Clear height (H) = distance between bottom edge of lintel and top edge of finished floor

Installation place	clear width (B)	clear wall opening (F)	clear height (H)

HUBER SE

Industriepark Erasbach A1 · D-92334 Berching
Phone: + 49 - 84 62 - 201 - 0 · Fax: + 49 - 84 62 - 201 - 810
info@huber.de · Internet: www.huber.de

Subject to technical modification
Drawing No. 190.161, 8.2010

Single security door TT2.1/WK3